

feather&black

Lymington Ottoman Bed

Product size: H x L x W (mm)

Single: 1270 x 2100 x 940

Small Double: 1270 x 2100 x 1240

Double: 1270 x 2100 x 1390

King: 1270 x 2200 x 1540

Super King: 1270 x 2200 x 1840

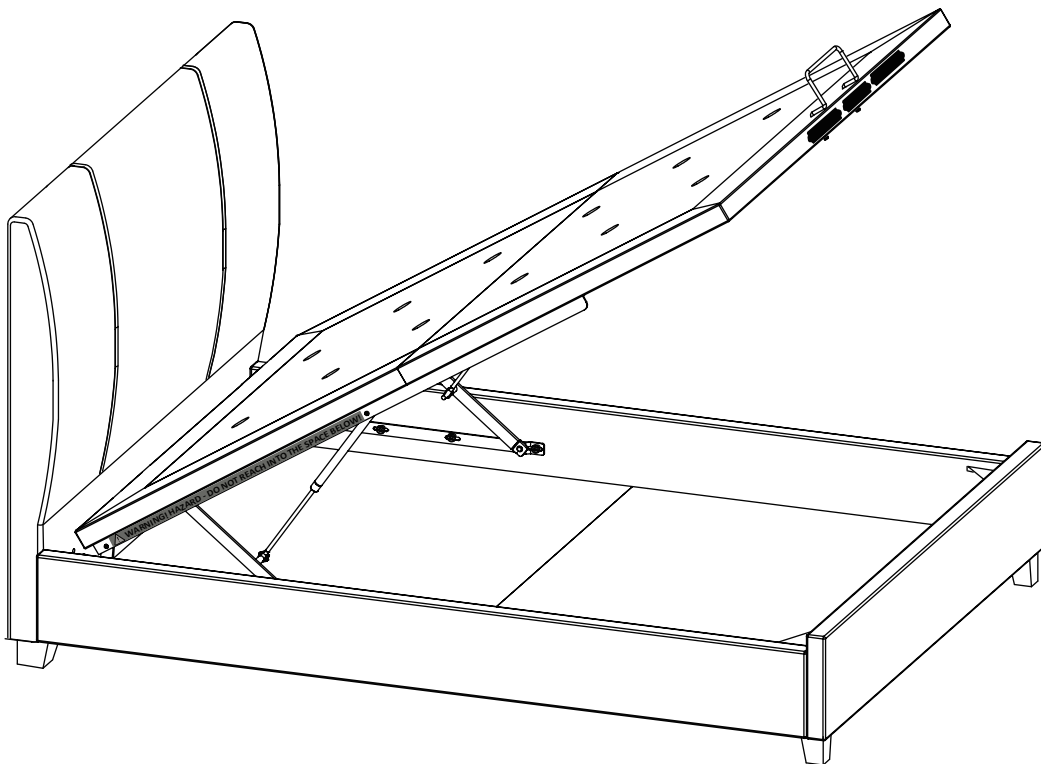

If you require any advice during assembly, please call our customer service team on 01243 380600

Please retain these assembly instructions for future use

feather&black

Lymington Ottoman Bed

IMPORTANT – READ CAREFULLY – RETAIN FOR FUTURE REFERENCE

- You must ensure that the mattress is on the bed frame before operating the lift mechanism – Failure to do so could result in injury.
- Keep hands clear of the mechanism when opening or closing the ottoman.
- Beware of entrapment – Never reach in through the mechanism to access the storage area.
- Always ensure that the ottoman is FULLY opened before accessing the storage area.
- Do not exceed the maximum weight as specified in the table below:

Bed	Bed Size	Min Weight (kg)	Max Weight (kg)
Lymington	Single	10	25
	Small Double	10	35
	Double	10	40
	King	15	45
	SuperKing	20	50



feather&black

Lymington Ottoman Bed

Before you start

Thank you for purchasing the Lymington Ottoman Bed.

Please read these instructions fully prior to assembly to familiarise yourself with the various stages of construction. Carefully open all packs supplied and check the contents against the parts and fittings check list. Do not destroy any of the packaging until you are certain that you have all the necessary parts for the assembly.

This item is heavy once assembled. Please try to assemble the item as close as possible to the point of use. Take care when moving the item to avoid personal injury or damage to the product and always lift rather than drag.

There are small components used in the construction of this furniture as well as plastic packaging, these should be kept away from young children whilst assembling.

Product Safety

All assembly fastenings should always be tightened properly and care should be taken to ensure that no fittings are loose.

Periodically check and ensure that all components are in their proper position, free from damage, and that all connectors are tight.

Please note depending on the lighting, positioning and surroundings of your room, the shade of the colour can sometimes appear slightly different. Over a period of time the colour might lighten or fade slightly due to light exposure.

Product Care

To clean, slightly moisten cloth with water and wipe surfaces. A damp cloth holds dust and prevents damage. repeat with a dry, soft, lint-free cloth or, if fabric, remove dust using a low suction vacuum cleaner.

Do not use abrasives or cleaning products which may contain ammonia or solvents as they will damage the finish.

Number of people required to assemble

Two people to assemble the product and two people to lift into position.



Important Advice

Do not operate the mechanism with anybody on the bed.

Time to assemble



1.5 hour approx
assembly time

No more tools needed.

Missing parts or faulty products

If you are missing any fixtures or fittings during assembly, or a part is unfortunately faulty, please call our customer service team on 01243 380600

feather&black

Lymington Ottoman Bed

Parts

Important information

The bed you have purchased comes with mattress base boards - please follow the instructions below in their current order.

To prevent accidents carefully read the ottoman safety warnings for this bed, on the first page of this guide.

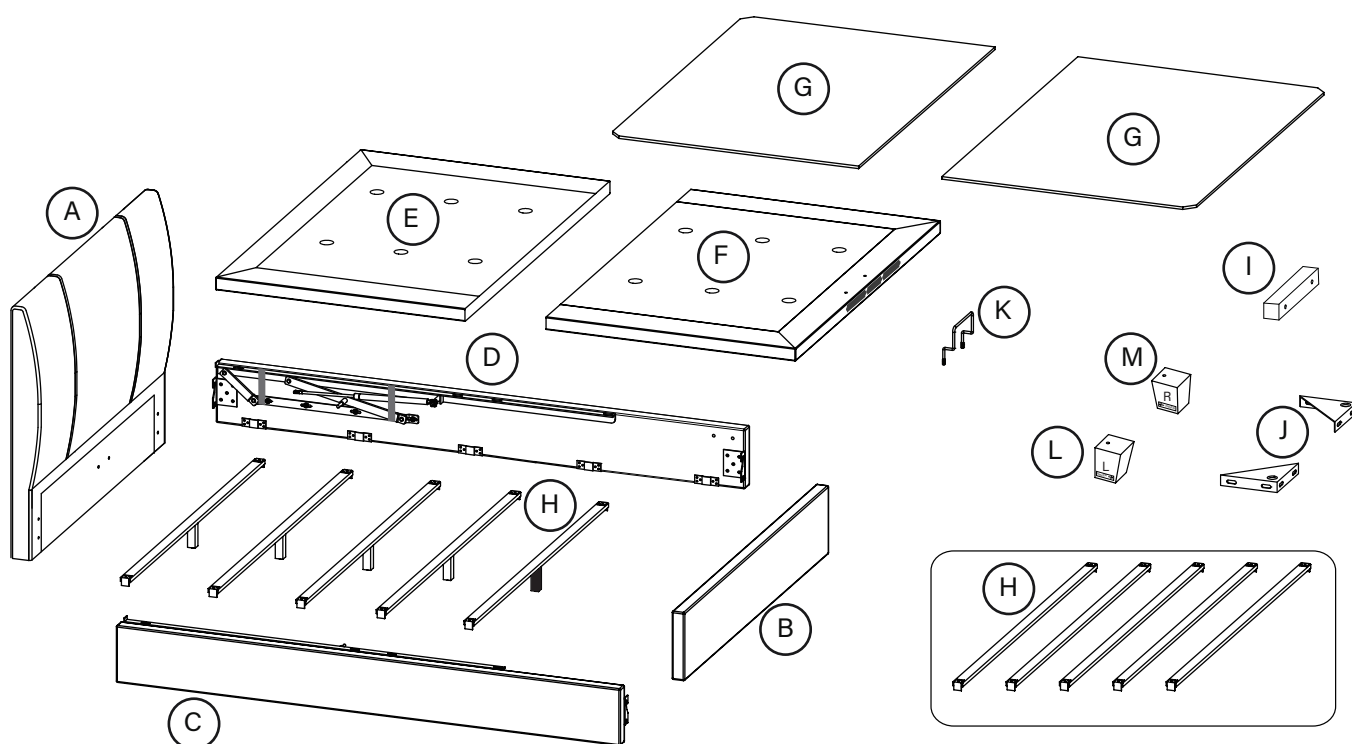

*In single size bed, the five base board support rails (H) are supplied without any central legs.

Parts list

A.	Headboard	1	H.	Base Board Support Rails (Wood)	5
B.	Footboard	1	I.	Mattress Base Support Rails	2
C.	Siderail - Left	1	J.	Angle Corner Brackets	2
D.	Siderail - Right	1	K.	Mattress Base Lifting Handle	1
E.	Mattress Base Board - Headend	1	L.	Feet - Left	2
F.	Mattress Base Board - Footend	1	M.	Feet - Right	2
G.	Storage Base Boards	2			

feather&black

Lymington Ottoman Bed

Fixture and fitting supplied (not actual size)

Please check you have all the parts listed below with your product:

Hardware needed for yting side rails to headboard & footboard packed in side rail pack 3 - hardware pack (A)

a x16

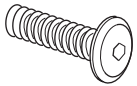

Bolts (M8x30mm) for yting side rails (C&D) to headboard & footboard (A&B)

b x16



Spring washers for M8 bolts

c x24



Flat washers for M8 bolts

d x1



Allen Key for M8 bolts

h x8

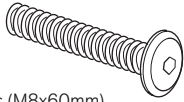

Bolts (M8x60mm) for yting feet (L&M) and mattress base support rail (I)

Hardware needed for fitting mattress base boards, packed in side rail pack 3 - hardware pack (B)

a x16

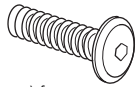

Bolts (M8x30mm) for yting gas-lift mechanism and metal connecting plates (j) to mattress base boards (E&F).

b x8



Spring washers for M8 bolts

c x16



Flat washers for M8 bolts

e x2

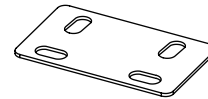

Metal plates for connecting mattress base boards (E&F)

f x1



Spanner for M8 nuts

g x2



Flanged M8 lock-nuts for gas-lift pistons

i x2



Domed M8 nuts (black) for yting mattress base lifting handle (K) to mattress base board (F)

j x4



Flat washers (black) for nuts (i)

Please Note:

Domed nuts 'i' & flat washers 'j' are pre-ytted to lifting handle (K)

feather&black

Lymington Ottoman Bed

1.

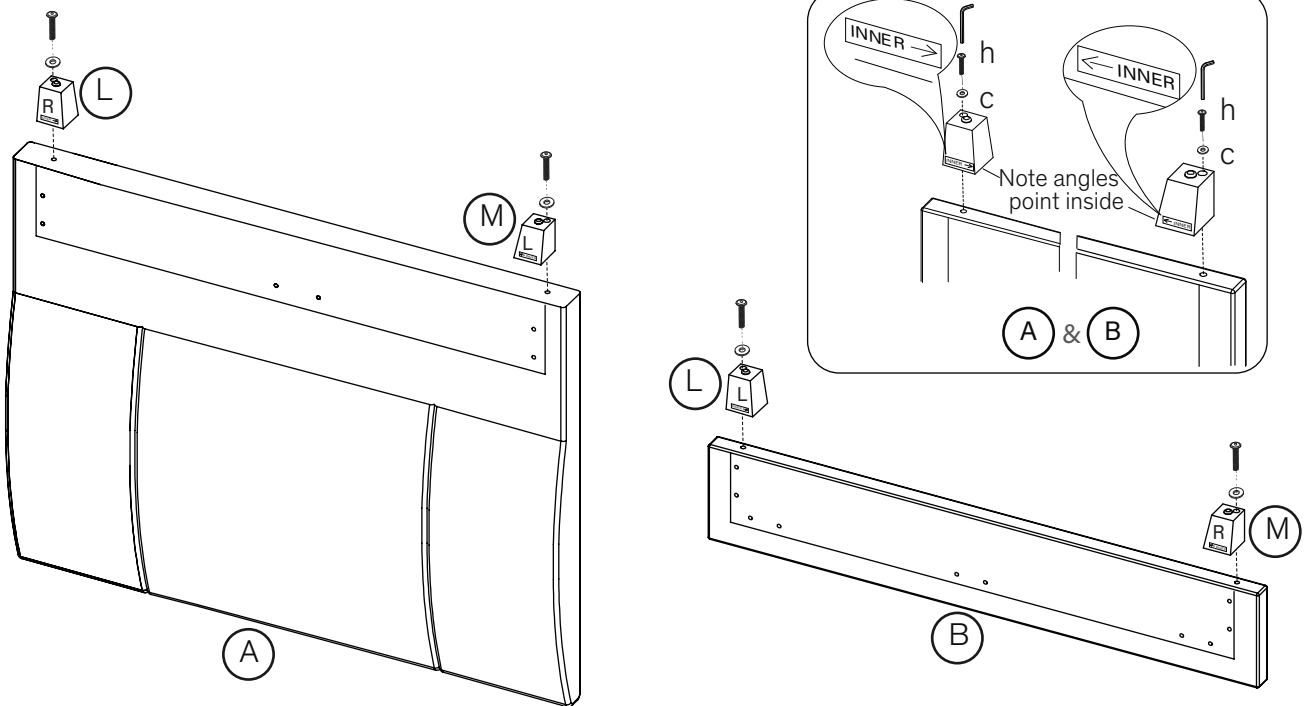

c



x4

d



x1

h

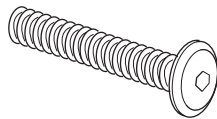

x4

2.

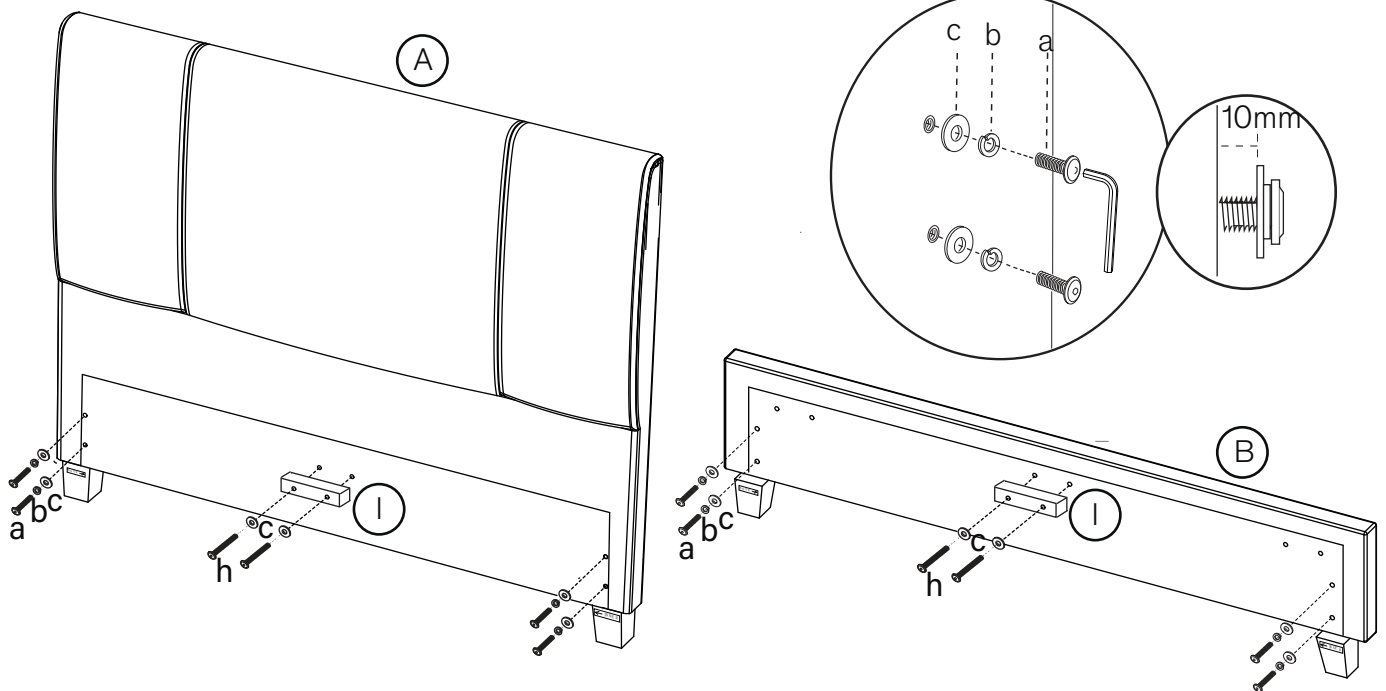

a

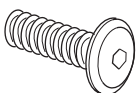

x8

b



x8

c



x12

d



x1

e

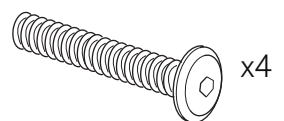

x4

feather&black

Lymington Ottoman Bed

3.

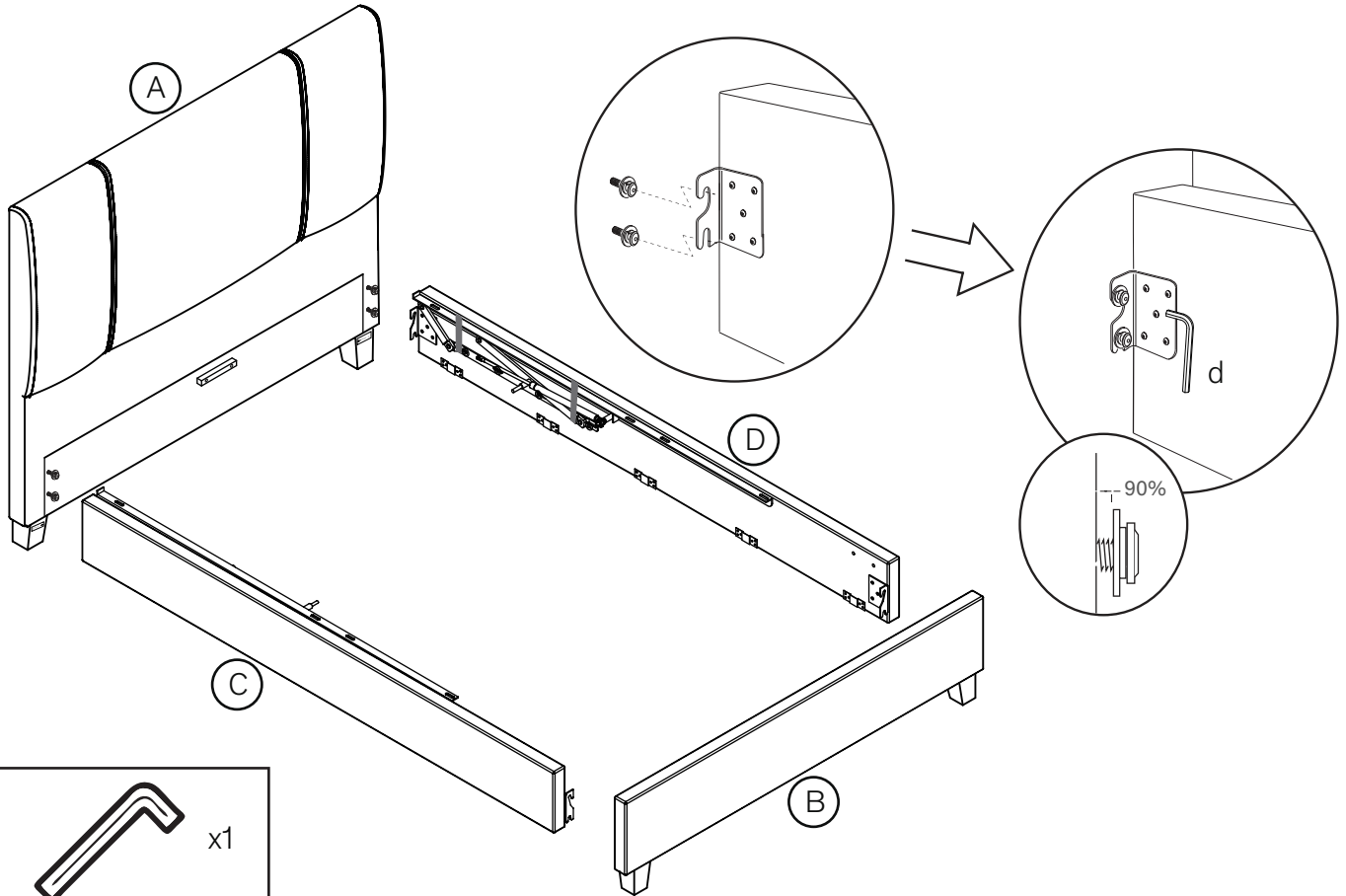

d



x1

4.

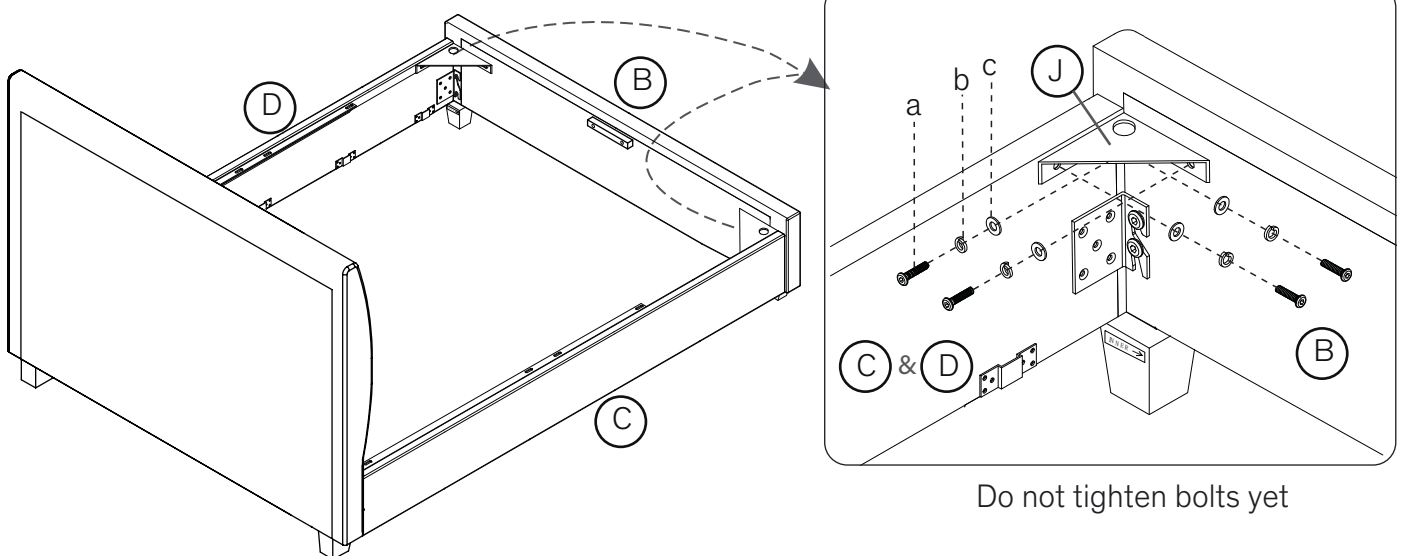

a

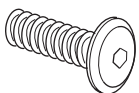

x8

b



x8

c



x8

d



x1

feather&black

Lymington Ottoman Bed

5.

i) Please note: on the single size bed, there are no central legs fitted to the base board support rails (H).

ii) On all the other size beds, the base board support rail with the black leg is the first support fitted into the brackets adjacent to the footboard.

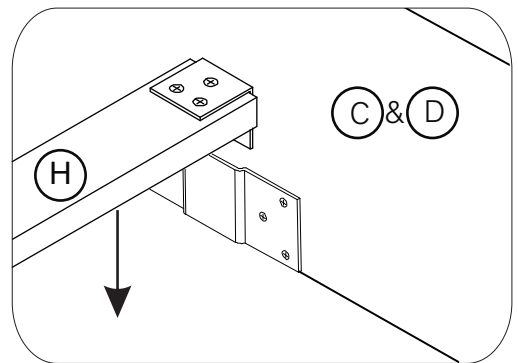
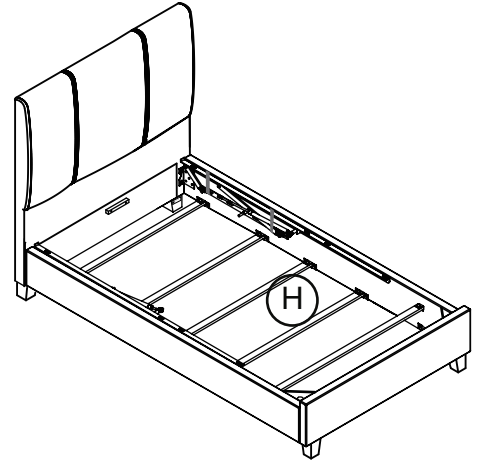
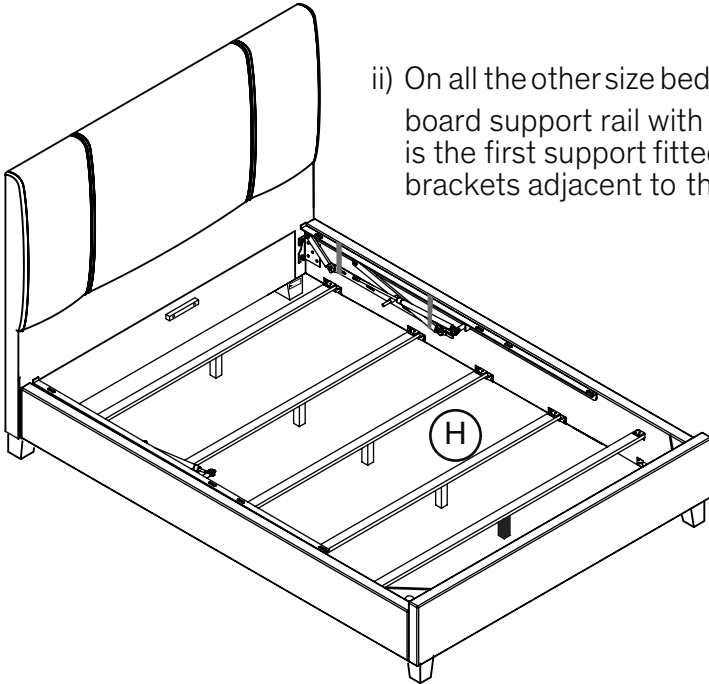

6.

After fitting the base board support rails, make certain the bed is squared up as shown in the diagram then tighten all bed assembly bolts 100%.

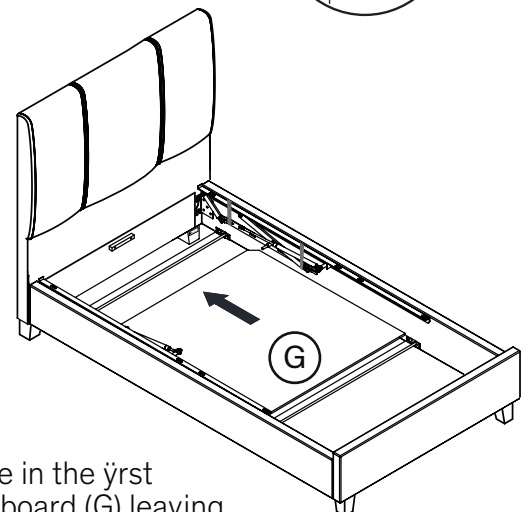
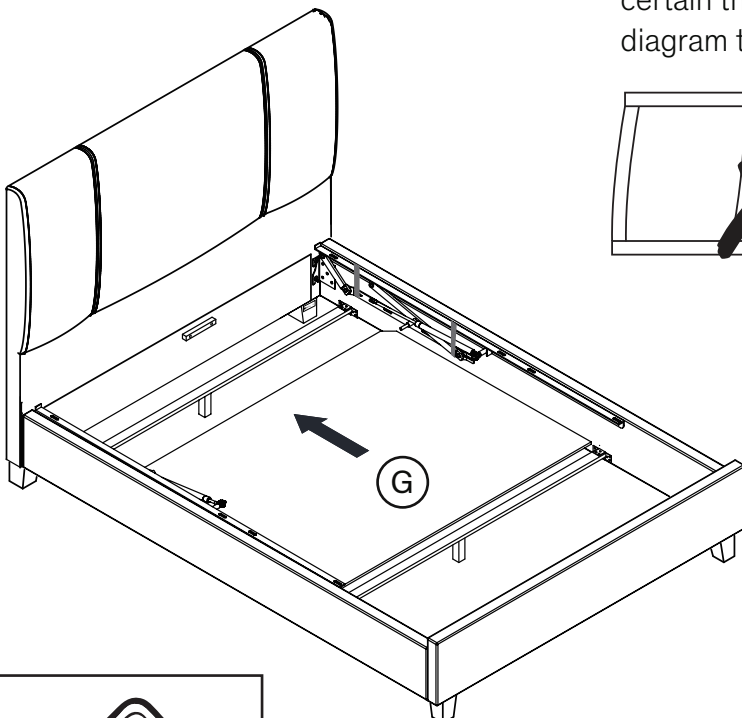
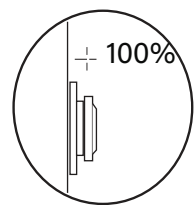
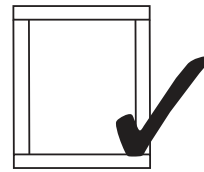
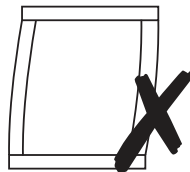

d



x1

Carefully slide in the first storage base board (G) leaving the second one until Step 10.

feather&black

Lymington Ottoman Bed

7.

i) Untie the two mechanisms.

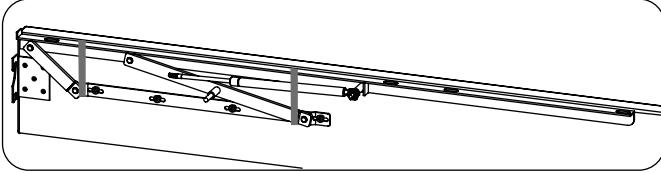

ii) Lift up mattress base board support bars.

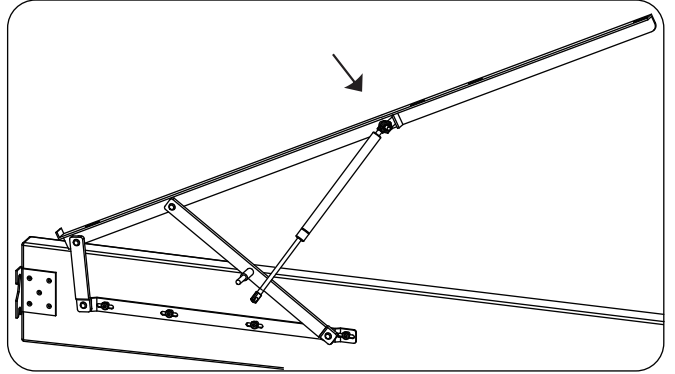

iii) Connect the piston stems

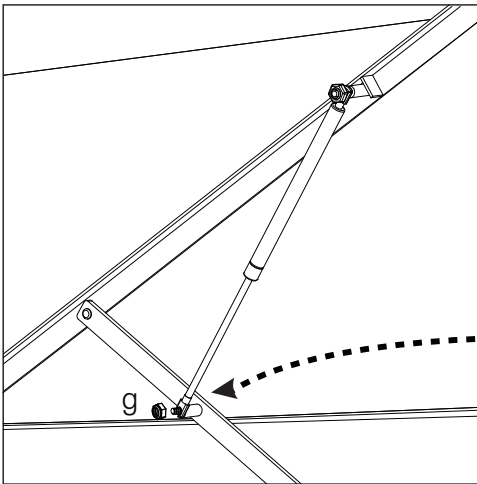

iv) Slide gas-lift piston stems onto the threaded axes then fit the flange lock-nut (g) and tighten with spanner (h).

Do not over-tighten as a small gap is needed so stem can rotate freely - please see the sketch.

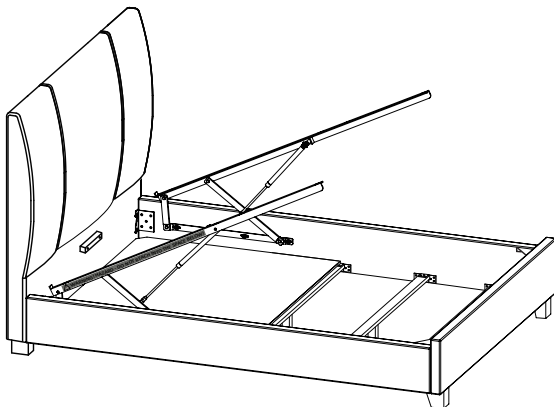
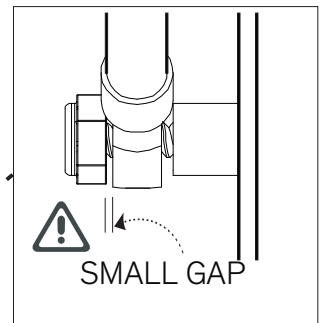
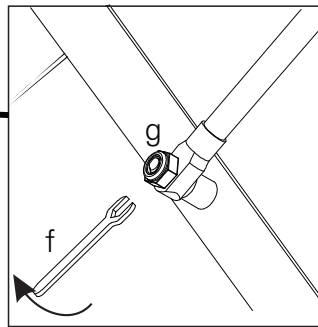

f



x1

g



x2

feather&black

Lymington Ottoman Bed

8.

i) Slide headend mattress base board (E) up against the lifting arm stop plates.

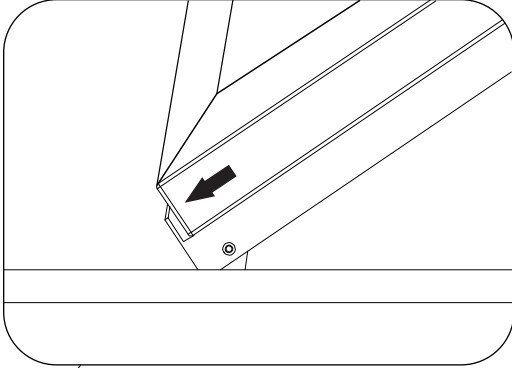

ii) Carefully screw x4 bolt sets into the base board as shown - do not tighten 100% yet.

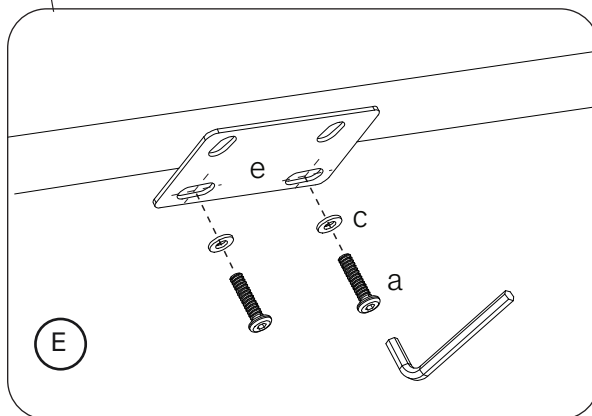
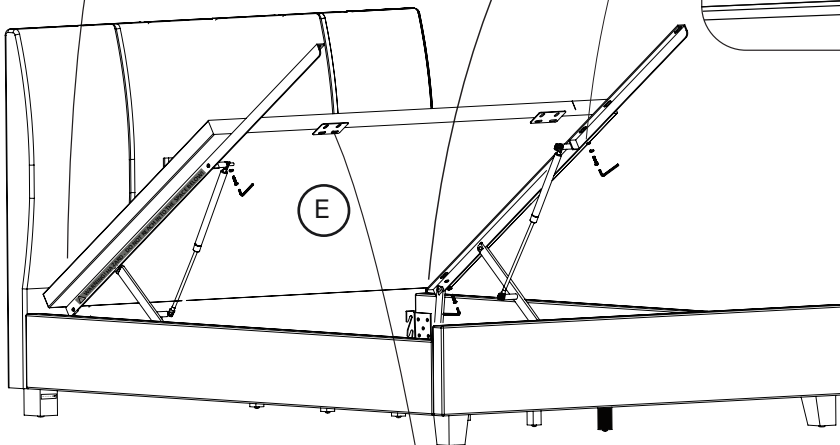
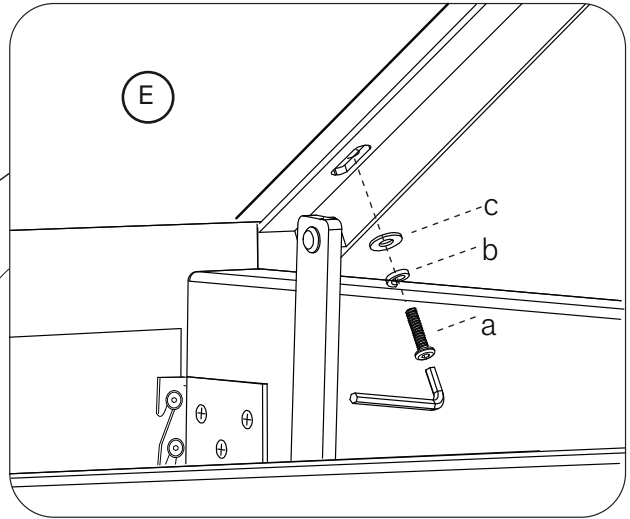

iii) Fit both connection plates (e) to headboard mattress base board (E) as shown, (before fitting second mattress base F).

a

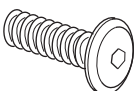

x8

b



x4

c



x8

d



x1

e

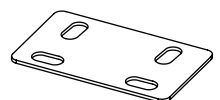

x2

feather&black

Lymington Ottoman Bed

9. i) Slide the footend mattress base board (F) into position.

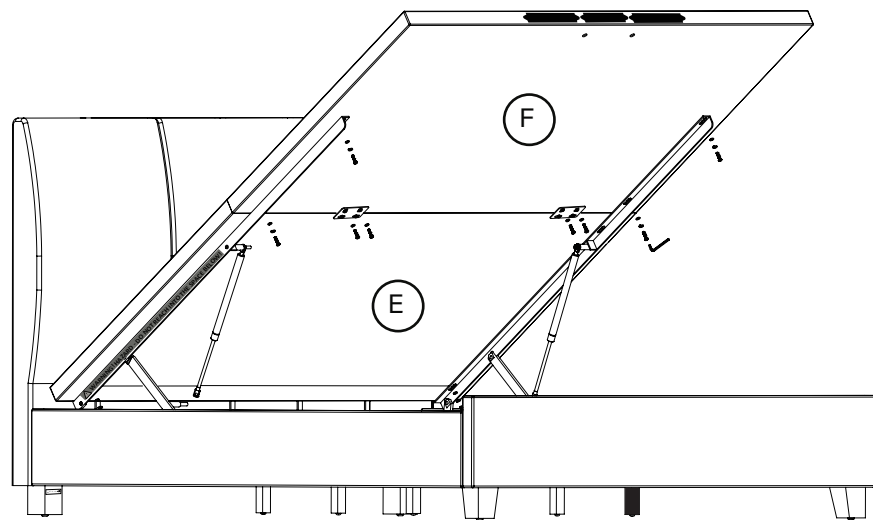
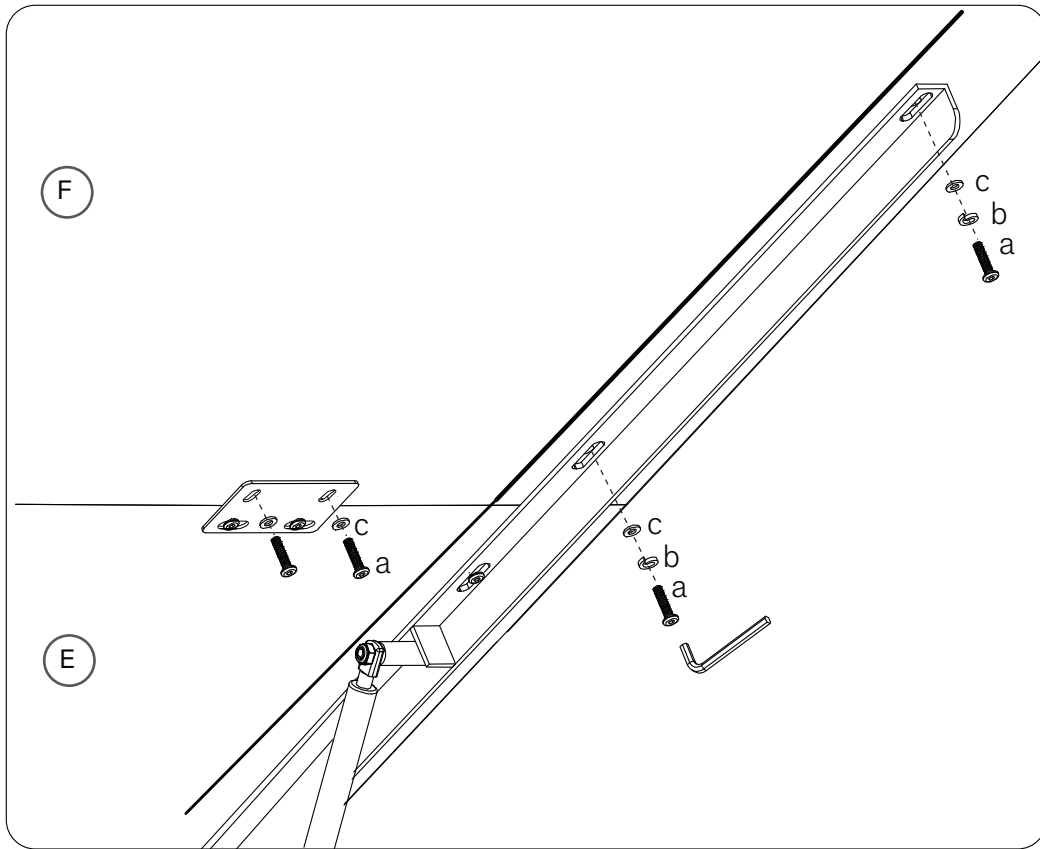

- ii) Loosely connect plates (c) to (F) then screw other x4 bolt sets through the supports into the base board.

When all x16 bolt sets are in place, tighten all 100%.

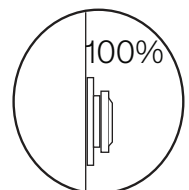

a		x8	b		x4	c		x8	d		x1
---	--	----	---	--	----	---	--	----	---	--	----

feather&black

Lymington Ottoman Bed

10.

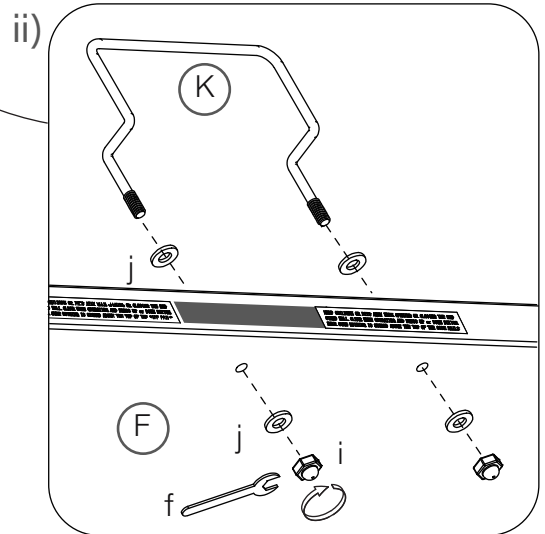
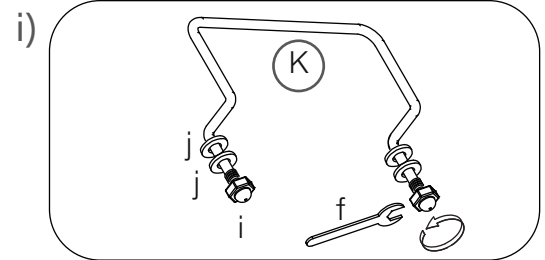
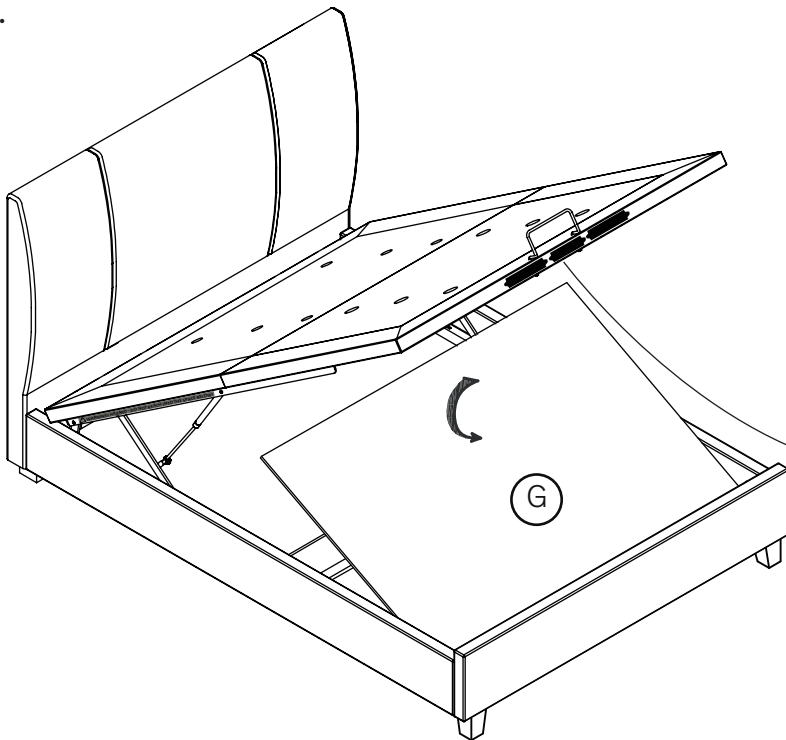

TO AVOID ACCIDENTS

TO ACCESS THE STORAGE AREA THE OTTOMAN FRAME
MUST BE FULLY OPENED AND FULLY CLOSED AFTERWARDS

- Keep hands clear of the mechanism when operating the base system
- Do not overload the internal storage base
- Do not allow children near the lift base when operating the mechanism
- Do not stand inside the internal storage area of the bed
- Do not reach into the storage area through the hinge mechanism

CAUTION

- TO BE OPERATED BY ADULTS ONLY
- KEEP CHILDREN OR PETS AWAY FROM THE STORAGE AREA
- TO AVOID TRAPPING YOUR FINGERS, USE ONLY THE HANDLE TO LIFT AND LOWER THE BASE
- BE CAREFUL WHEN LIFTING, ONLY LIFT WITH THE MATTRESS IN PLACE

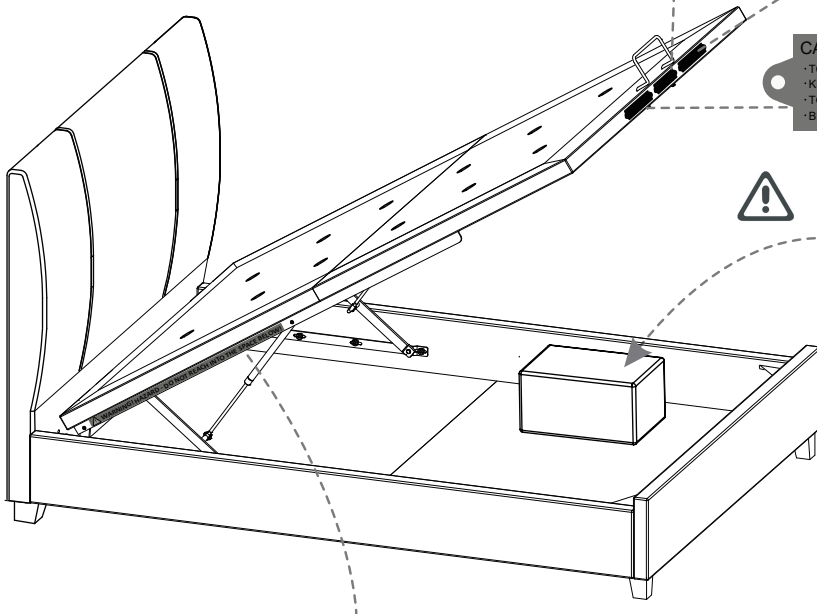

Note: Be very careful what you store under the bed - the top of an item, like a suitcase or a box, must not touch the underside of the mattress base or it may get damaged.
Maximum item height is 225mm.

! WARNING! HAZARD - DO NOT REACH INTO THE SPACE BELOW!

feather&black

Lymington Ottoman Bed

IMPORTANT - READ CAREFULLY

- Use caution when operating, always use the handle when lifting
- Note: This bed uses a pressurised mechanism.
- To be operated by adults only
- Please ensure that children and pets are kept away from the bed when operating the lift mechanism.
- Keep children and pets away from the storage area.
- Do not overload the internal storage base.
- Do not stand inside the internal storage area of the bed
- Before removing the mattress secure the frame to ensure it does not open unexpectedly.
- Do not attempt to lie on the mattress when the ottoman is in the raised position.
- When lifting the ottoman remove all bedding except the fitted sheet.
- You must ensure that the mattress is on the bed frame before operating the lift mechanism – Failure to do so could result in injury.
- Keep hands clear of the mechanism when opening or closing the ottoman.
- Beware of entrapment – Never reach in through the mechanism to access the storage area.
- Always ensure that the ottoman is FULLY opened before accessing the storage area.
- Do not exceed the maximum weight as specified in the table below:

Bed	Bed Size	Min Weight (kg)	Max Weight (kg)
Lymington	Single	10	25
	Small Double	10	35
	Double	10	40
	King	15	45
	SuperKing	20	50



feather&black

Lymington Ottoman Bed

Overall Dimensions (LWH mm)

Single:	2100 x 940 x 1270
Small Double:	2100 x 1240 x 1270
Double:	2100 x 1390 x 1270
King:	2200 x 1540 x 1270
Super King:	2200 x 1840 x 1270

Storage Dimensions (LWH mm)

Single:	1940 x 830 x 225
Small Double:	1940 x 1130 x 225
Double:	1940 x 1280 x 225
King:	2110 x 1430 x 225
Super King:	2110 x 1730 x 225

Ottoman Piston Rating (n)

Single:	600
Small Double:	750
Double:	900
King:	1000
Super King:	1200

